



## Product Preview Zero-Turn Rotary Mower

# ZT600™

### Dependable Performance. Professional Results.

The new Jacobsen ZT600 Series delivers the productivity, comfort, and reliability expected with over 95 years of industry leading turf innovation.

- **High Horsepower** – Features fuel efficient engines from Kawasaki® FX and Kohler® EFI to power you through up to 4.8 acres per hour.
- **Cutting System** – Offered in three cutting widths (48-, 54- and 60-inch), decks easily tackle large volumes of grass and provide a more attractive after-cut appearance.
- **Proven Drivetrain** – Parker® HTJ transmissions provide smooth, reliable steering and are up to 15% more fuel efficient than the competition.
- **Robust Deck Spindle** – The Turf Xtreme™ spindles are maintenance free and provide longer bearing life with Contamination Exclusion Technology. The high-strength ductile iron is 60% stronger than aluminum housings.
- **Optional Accessories** – Add an electric deck lift for easy deck height adjustments, or a foot-operated Operator Controlled Discharge Chute for opening and closing the discharge chute on the fly.



**ZT600**  
2460KW

#### ZT600 MODELS:

**2248KW:** 22 hp, 48-inch Deck  
**2548KOE:** 25 hp, 48-inch Deck  
**2454KW:** 23.5 hp, 54-inch Deck  
**2554KOE:** 25 hp, 54-inch Deck  
**2460KW:** 23.5 hp, 60-inch Deck  
**2560KOE:** 25hp, 60-inch Deck

\*Actual production model may vary.

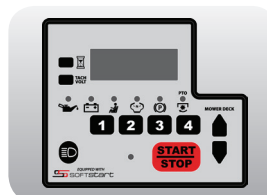

**InCommand Console** – Keyless ignition, "SoftStart" clutch engagement, and more

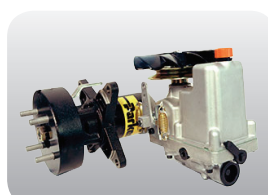

**Parker® HTJ** – 12cc pumps and integrated wheel motor for fast and smooth steering



**PEER® Spindles** – Sealed with Contamination Exclusion Technology for reliable performance

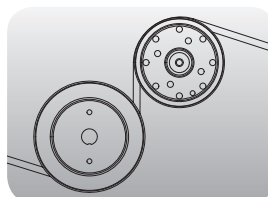

**Perfect Tension™** – Constant belt tension to increase belt life expectancy up to three times

**PRELIMINARY PRODUCT INFORMATION**  
*Subject to change*

1.888.922.TURF | [www.jacobsen.com](http://www.jacobsen.com)

# ZT600™

## Product Preview

### PRELIMINARY SPECIFICATIONS

	48-inch Deck		54-inch Deck		60-inch Deck	
Model	2248KW	2548KOE	2454KW	2554KOE	2460KW	2560KOE
Engine						
Manufacturer	Kawasaki® FX	Kohler® Confidant EFI	Kawasaki® FX	Kohler® Confidant EFI	Kawasaki® FX	Kohler® Confidant EFI
Horsepower	22 hp	25 hp	23.5 hp	25 hp	23.5 hp	25 hp
Displacement	726cc	747cc	726cc	747cc	726cc	747cc
Air-cleaner	2 stage					
Cooling	Air cooled					
Starter	Electric					
Engine warranty	3 Year					
Drive System						
Dual hydrostatic	Parker® HTJ					
Ground speed	10 mph					
Parking brake	Integrated in transaxle					
Towing capacity	200 lbs					
Mower Deck						
Deck size	48 in		54 in		60 in	
Acres/hour	3.8		4.3		4.8	
Cutting height	1 in - 5 in					
OCDC (operator controlled discharge chute)	Foot-operated (optional)					
Deck height adjustments	Manual lift, 1/4 in increments					
Electric lift	Optional					
Deck engagement	Ogura® 150 ft-lbs					
Construction	7 ga formed & welded					
Blades	(3) - 2.5 in x 17.25 in		(3) - 2.5 in x 19 in		(3) - 2.5 in x 20.5 in	
Blade tip speed (approximate)	18,398 fpm		18,257 fpm		18,541 fpm	
Spindles	1 in effective diameter machined shaft					
Spindle housings	Peer® Turf Xtreme™ ductile iron (sealed)					
Anti-scalp rollers	4					
Pulleys	7 ga steel deep groove					
General						
Battery	12 Volt, 300cca					
Digital display	InCommand™ Console - Tachometer, hour meter, fuel gauge, engine warnings, ignition					
Fuel capacity	6.8					
Rear tires	23 x 9.5-12 GrassMaster		23 x 10.5-12 GrassMaster			
Front tires	13 x 6.5-6					
Frame	Welded C-channel, 7 ga formed					
Floor-pan	Removable, steel					
Seat	Full suspension seat w/ padded armrest					
Springer Forks	Optional accessory					
Dimensions						
Overall height (rollbar down)	50 in					
Overall height (rollbar up)	71 in					
Overall width (chute down)	63.6 in		69.6 in		76 in	
Overall width (chute up)	49.2 in		55.4 in		61.9 in	
Overall length (rollbar down)	85.8 in					
Overall length (rollbar up)	81.3 in					
Weight	1116 lbs	1121 lbs	1132 lbs	1138 lbs	1140 lbs	1144 lbs

\*Acres/hour at top speed and 80% efficient

Engine horsepower is provided by engine manufacturer. Actual operating power output may vary due to conditions of specific use.

NOTE: Specifications, while correct at time of printing, may change without notice.

1.888.922.TURF | [www.jacobsen.com](http://www.jacobsen.com)

